



Client _____ Quantity _____
Project _____ Position _____

FUN 700

Model: F70/70FTE/SL/A

Cod: MP01372123035

Technical data

Modularity:	On open cabinet
Dimension (mm):	700x700x850
Total electric power (kW):	9
Cooking zone dimensions 1 (LxD mm):	696x520
Electric power (V):	380-415
Ampere (A):	14
Phases:	3N
Cable section (mmq):	5G2,5
Frequency (Hz):	50-60
Net volume (m3):	0,417
Packing dimensions (mm):	776x776x1180
Gross weight (kg):	97
Gross volume (m3):	0,711

Features

Working top:	Made of AISI 304 stainless steel with a thickness of 10/10 mm
Material of plate:	Satin chrome
Plate finish:	Smooth
Knobs:	Knobs are made from a sturdy heat-resistant polymer blend and are equipped with liquid anti-leakage washer
Plate:	Satin chrome plate

Electric griddle with polished chromed grooved plate top version. Top made of AISI 304 stainless steel thickness 8/10; covering in AISI 304 stainless steel thickness 8/10; external reinforcements made of anti-corrosion material (aluminised sheet metal); bottoms and internal parts in AISI 430 steel; flue cover in enamelled steel. Chromed steel plate with high thermal conductivity for even temperature distribution. Equipped with front groove and pull-out drawer for collection of residual fats. Cooking zone equipped with 3 shielded heating elements which are thermostat controlled in a range of use from 50° to 300° C. Safety thermostat and indicator lights to show correct operation. - 3 plates x 1.5 kW - Total power 4.5 kW Cooking plate dimensions 395x550 mm. Electrical power supply VAC 400 + 3N 50÷60 Hz. Can be set up on "bridge system", or on neutral base with optional doors

Technical draw

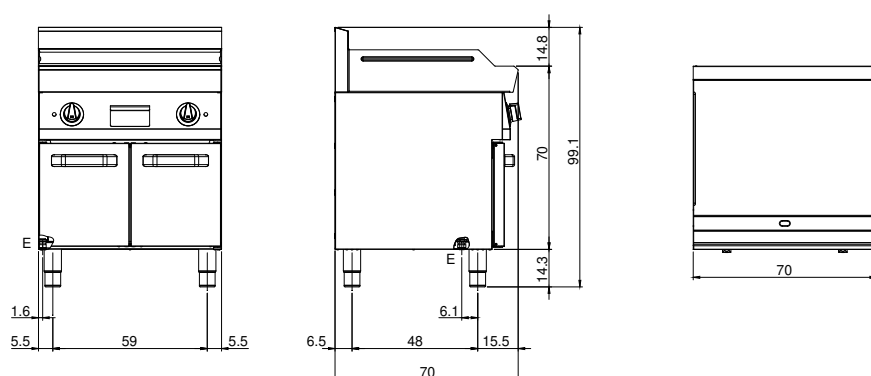

E: Electric power