



Client _____ Quantity _____
 Project _____ Position _____

FUN 700

Model: F70/40FTG/SR/A

Cod: MP01372113031

Technical data

Modularity:	On open cabinet
Dimensions (mm):	400x700x850
Total gas power (Kcal/h):	4902
Total gas power (kW):	5,7
Cooking zone dimensions 1 (LxD mm):	396x520
Gas connection:	1/2"
Net volume (m3):	0,238
Packing dimensions (mm):	477x776x1147
Gross weight (kg):	61
Gross volume (m3):	0,425

Features

Working top:	Made of AISI 304 stainless steel with a thickness of 10/10 mm
Material of plate:	Satin chrome
Plate finish:	Ribbed
Knobs:	Knobs are made from a sturdy heat-resistant polymer blend and are equipped with liquid anti-leakage washer
Plate:	Satin chrome plate
Kit Gas:	Natural gas conversion kit 30/50 m/bar (tested with natural gas G20)

Gas griddle with smooth plate Top in AISI 304 stainless steel thickness 8/10; covering in AISI 430 stainless steel 8/10; bottoms and internal parts in AISI 430 steel; internal reinforcements made of anti-corrosion material. (aluminised sheet metal). Provided with front groove, extractable drawer for grease collection and splash guard on three sides. Equipped with burner with pilot burner with piezoelectric ignition. Gas supplied by means of safety valve with thermocouple and pilot burner for automatic burner lighting. 1 burner x 5.7 kW. Plate dimensions 395x520 mm.

Technical draw

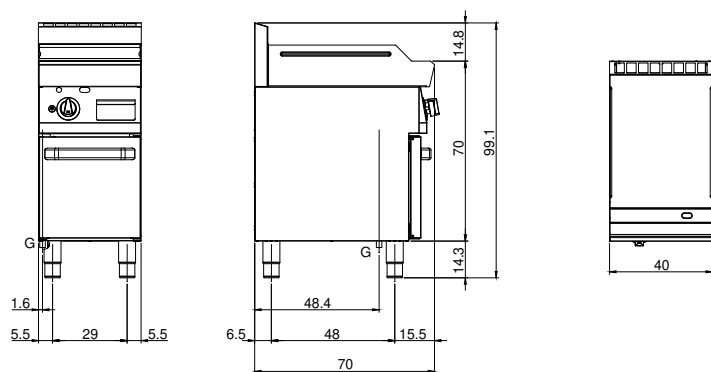

G: Gas connection 1/2"