



Client \_\_\_\_\_ Quantity \_\_\_\_\_  
Project \_\_\_\_\_ Position \_\_\_\_\_

## ROC 700

Model: R70/80CFEQ

Cod: MP01034123010

### Technical data

Modularity:	Electric oven
Dimension (mm):	800x730x870
Oven dimension (mm):	555x660x257
Total electric power (kW):	16,4
Oven type:	Static oven
Oven power (kW):	6
Oven temperature range (°C):	50-300
Electric power (V):	380-415
Ampere (A):	25,5
Phases:	3N
Cable section (mmq):	5G4
Frequency (Hz):	50-60
Net volume (m3):	0,508
Packing dimensions (mm):	880x856x1109
Gross weight (kg):	111
Gross volume (m3):	0,835

### Features

Working top:	Made of AISI 304 stainless steel with a thickness of 20/10 mm
Knobs:	Made of aluminum with IPX5 water protection
Handles:	The brushed aluminum handles allow for a secure and sturdy grip with a ergonomic lines
Flue:	Removable gas exhaust flue grill made of cast iron

Electric hob with 4 square plates on electric oven. Side panels, bottom and back made in stainless steel. Pressed top made in AISI 304 thickness 20/10 with control edge for liquid collection iron designed for flush alignment. Rear flue made in enamelled cast-iron. N° 4 square electric plates dim. 220X220 mm each with 2.6 kW, equipped with safety thermostat and automatic recovery. 6 levels temperature control for each plate. Lamp on control panel to indicate the activation of electric supply and plates operation. Electric static oven GN 2/1. Heating by electric upper and lower heating elements with independent regulation. Temperature regulation by thermostat, from 50 °C to 300 °C. Safety thermostat. Lamp on control panel to indicate oven heating activation. Cooking chamber made in stainless steel. Oven inner door made in stainless steel with labyrinth seal. Oven power 6 kW. Special design knobs to avoid water penetration in the control panel. Adjustable feet made in stainless steel. IPX5 protection rating. Electric power supply VAC 400 3N 50÷60 Hz - 16.4 kW.

## Technical draw

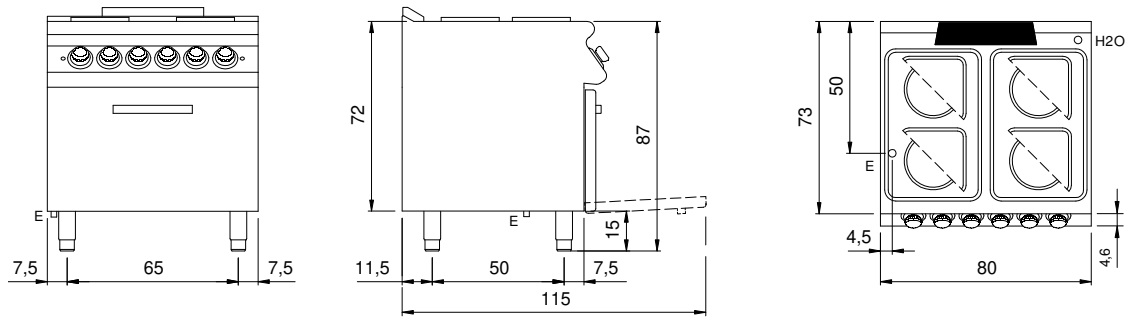

E: Electric power